

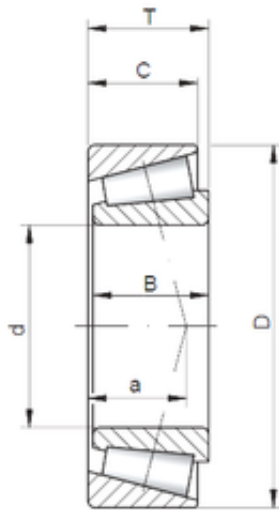

MANUFACTURING MEXICO,S.A.DE C.V.



44,45 mm x 111,125 mm x 36,957 mm ISO
535/532A tapered roller bearings

Bearing No. 535/532A

Size	44.45x111.125x38.1 mm
Bore Diameter	44,45 mm
Outer Diameter	111,125 mm
Width	38,1 mm
d	44,45 mm
D	111,125 mm
T	38,1 mm
B	36,957 mm
C	30,162 mm
a	12,2 mm

535/532A Bearing 2D drawings and 3D CAD models