

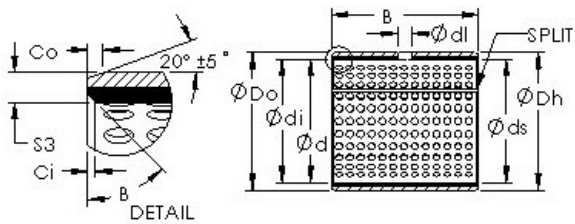

MANUFACTURING MEXICO,S.A.DE C.V.



AST AST20 561B60 plain bearings

Bearing No. AST20 561B60

Bore Diameter	88,9 mm
Outer Diameter	93,6752 mm
Bearing Type	straight
Shaft Dia., Nominal (d)	3.5000
Shaft Size (ds)	3.4844 / 3.4822
Housing Bore Dia. (Dh)	3.6889 / 3.6875
Bearing Outside Diameter, Nominal(Do)	3.688
Bearing Bore after Mounting (di)	3.4959 / 3.4893
Average Clearance (Cd)	0.0090
Wall Thickness (S3)	0.098
Bearing Length, Nominal (B)	3.750
Bearing Length Tolerance (B tol.) - +.010 / -0.010	+0.010 / 0.010
OD Chamfer Length (Co)	0.070
ID Chamfer Angle (B deg.)	45
ID Chamfer Length (Ci)	0.031
Lube Hole Dia. (dl)	0.375
Material	Carbon steel shell with POM plastic liner

AST20 561B60 Bearing 2D drawings and 3D CAD models